



PNEUMATIC PUMP WITH 20 KG (44 LBS) RESERVOIR

254000
254020-
254022
254500
2513000

The assemblies described here consist of a pump 234150* complet with suction filter and follower plate for grease, mounted in a 20 kg (44 lbs) reservoir which is available in 3 versions:

- With flanges for floor mounting
- Mounted on a 3-wheel trolley
- Mounted on a 2-wheel trolley

These units can also be furnished, with dispensing gun Part # 1151000* and its hose.

Normally this pump is furnished with a 200 cm (78.74 in.) hose, it is possible to obtain a longer hose by ordering Part # 2513021 and adding the desired length.

Example: for 500 cm (196.85 in.) hose
2513021 + 500 = Part # 25130521

Also available on request is hose for air supply, Part # 101100, when ordering specify the desired length.

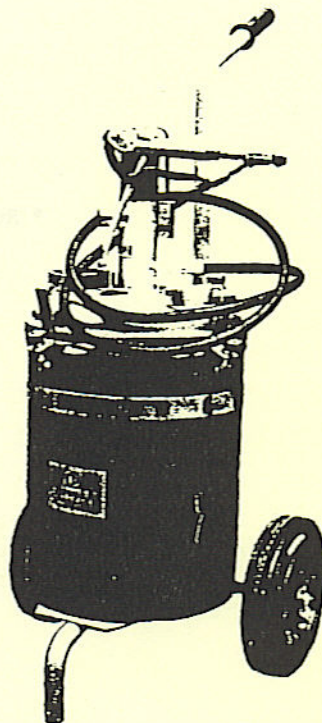

TECHNICAL FEATURES

- Ratio: 40:1
- Air supply pressure: 2 to 14 bar (30 to 200 psi)
- Lubricant pressure: 80 to 560 bar (1160 to 8100 psi).

Part # 234150 Pumps mounted on 20 kg reservoir	Without gun, rotary connector, flex	Complete with gun, rotary connector, flex
With follower plate	254021	2513000*
With follower plate. Mounted on a two- wheel trolley	254020	254500*
With follower plate. Mounted on a three- wheel trolley	254022	254000*
* Length of flex 200 cm (78.74 in.) - Part # 2513005		

* For maintenance and spare parts see the specified instruction sheet enclosed.

254000
254020
254022
254500
2513000

PNEUMATIC PUMP WITH 20 KG (44 LBS) RESERVOIR



ASSEMBLY 2513000

ASSEMBLY 254021

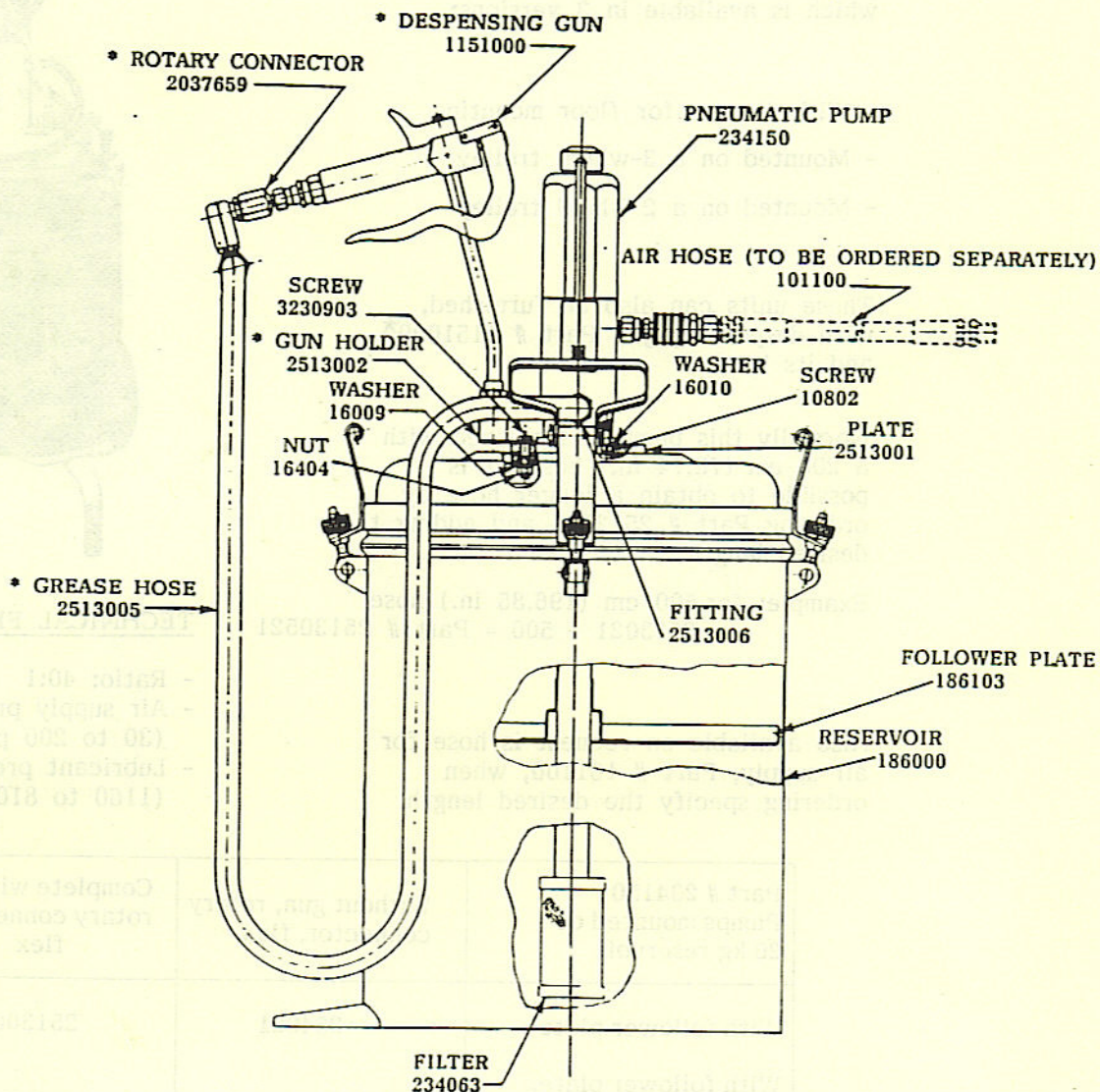

* ONLY FOR ASSEMBLY 2513000



PNEUMATIC PUMP WITH 20 KG (44 LBS) RESERVOIR

254000
254020
254022
254500
2513000

ASSEMBLY 254000

ASSEMBLY 254022

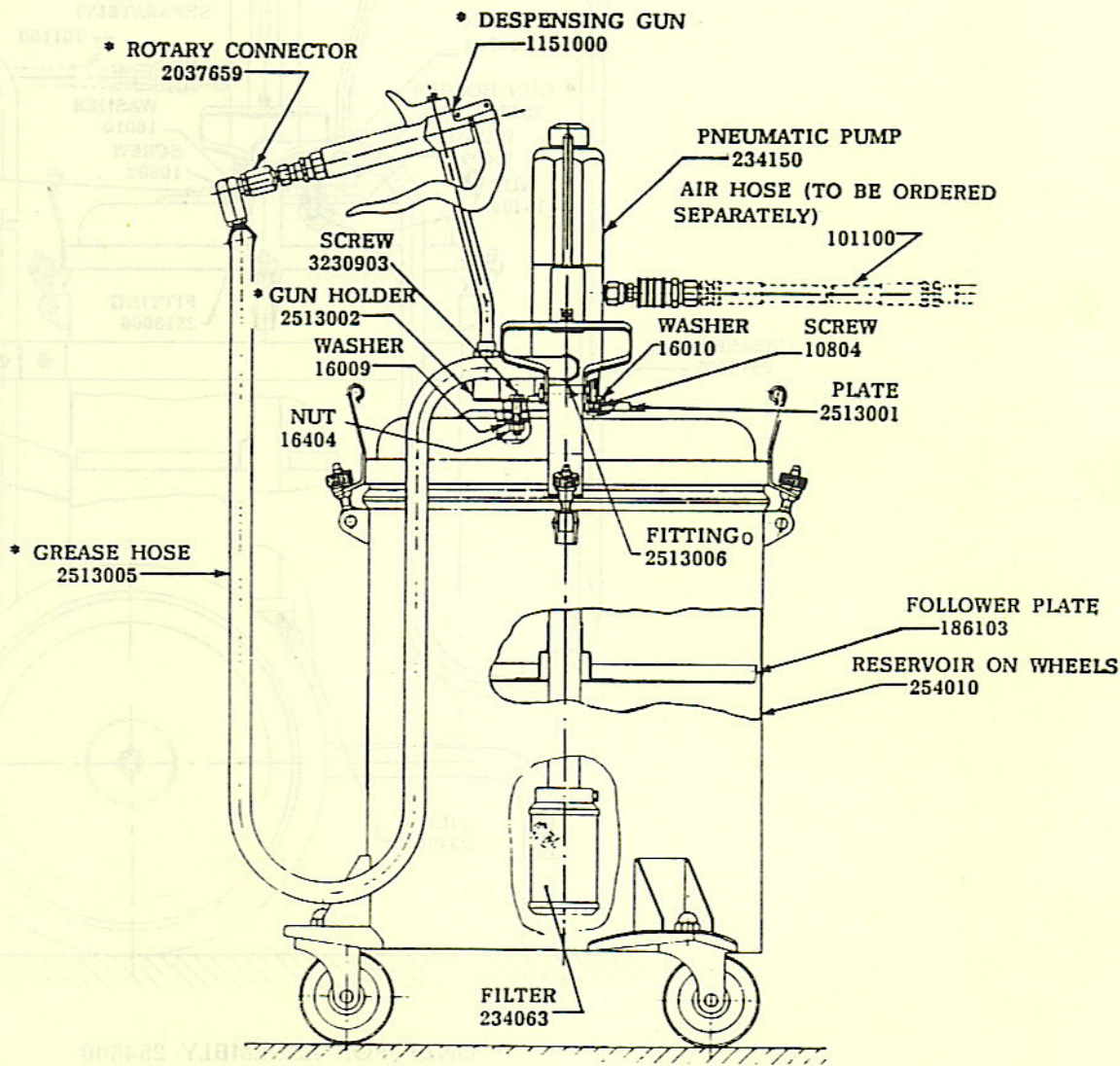

* ONLY FOR ASSEMBLY 254000

254000
254020
254022
254500
2513000

PNEUMATIC PUMP WITH 20 KG (44 LBS) RESERVOIR



ASSEMBLY 254500

ASSEMBLY 254020

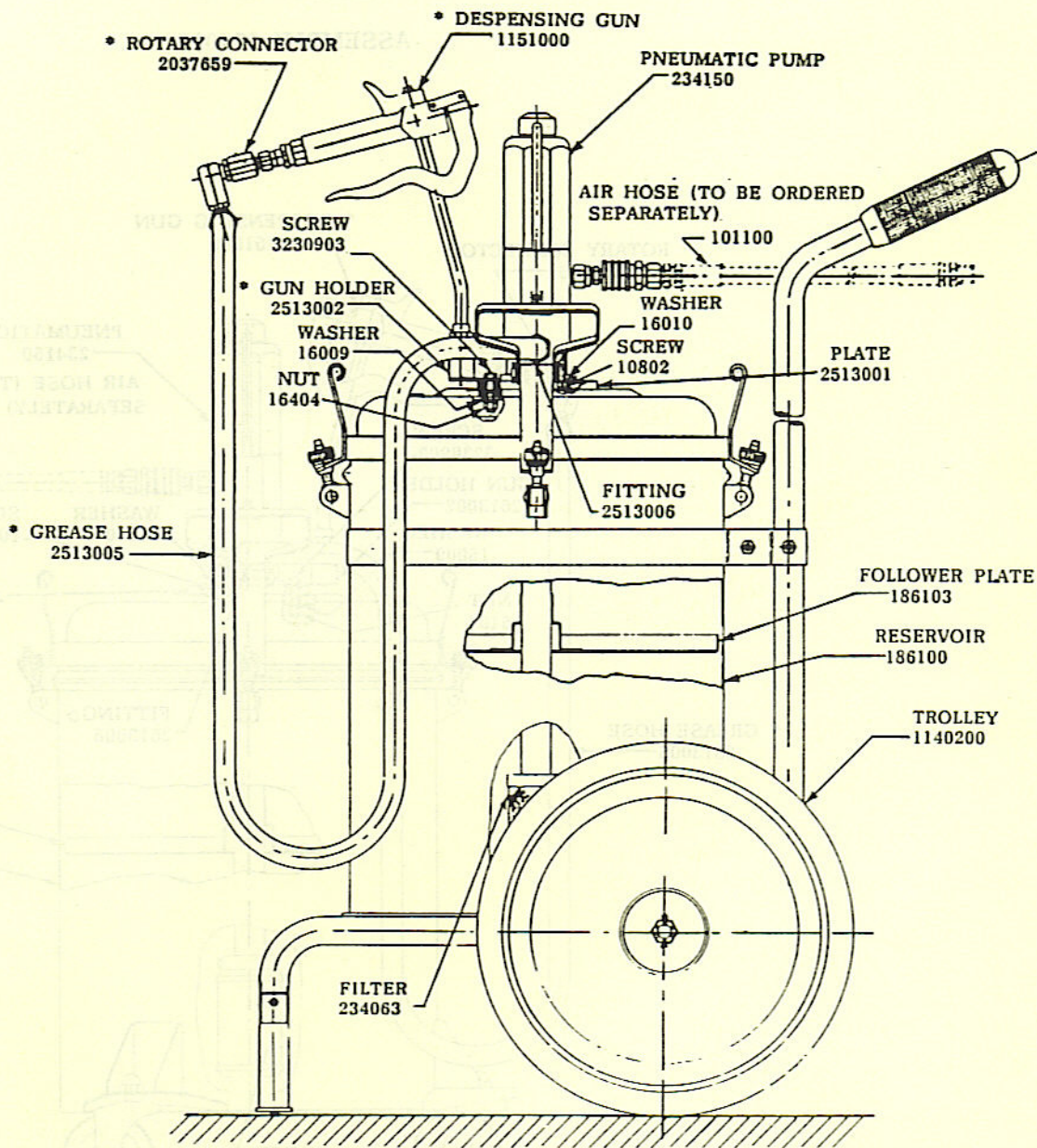

* ONLY FOR ASSEMBLY 254500